

PŮDORYS I.N.P. - přízemí M = 1 : 100

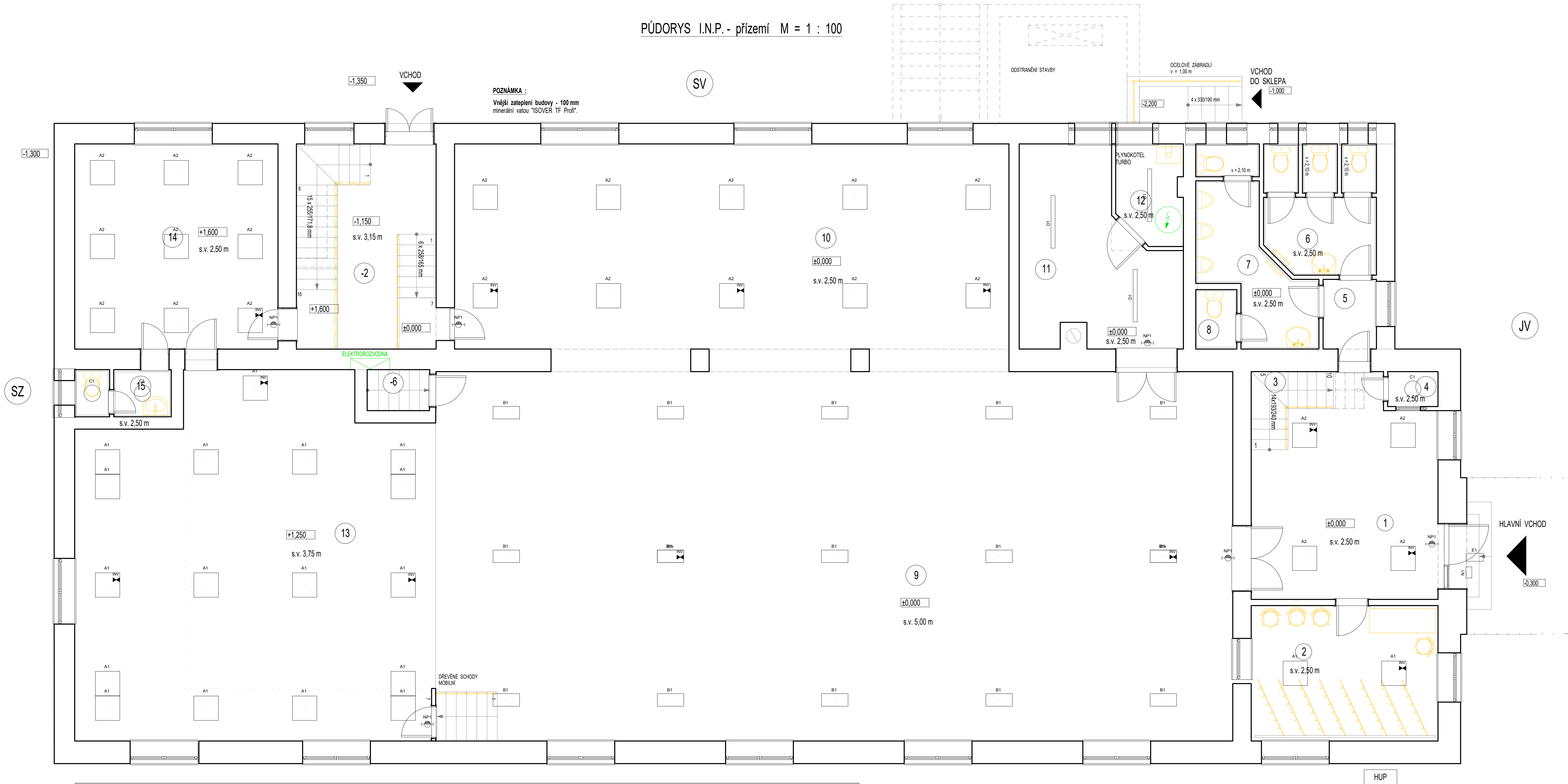

| Označení svítidla | Typ | Název | Světelné zdroje | Počet |
|-------------------|--|---|---|-------|
| A1 | PNL076-PLUS-KIT01-32W | 34W Backlit Panel Pro - Plus, 600x600mm, 840 with Driver | 1 x LED 4000k, 34W, 3300lm, Ra80, 4000K | 23 |
| A2 | PNL076-PLUS-KIT01 | 27W Backlit Panel Pro - Plus, 600x600mm, 840 with Driver | 1 x LED 4000k, 27W, 2750lm, Ra80, 4000K | 42 |
| B1 | MBHP050-840-C60-PC-SSD | Midi-Bay HP 50W/840 C60 PC (12963) DALI IP65 | 1 x HARLUX2D33, 53W, 7150lm, Ra80, 4000K | 15 |
| B1x | Midi-Bay-HP-EMG1 HO ST-06W-840-(90 min.) | Midi-Bay-HP-EMG1 HO ST-06W-840-(90 min.) | 1 x FULOS42 HO 6W, 6W, 890lm, Ra80, 4000K | 2 |
| C1 | PX3000213 | MODENA LED 25W 4000K | 1 x LED 5630, 25W, 3010lm, Ra89, 4000K | 10 |
| D1 | COV112-11-840-080-0000 | COVENTINA 112 39W/840 PC/PCO 5340lm 1050mA IP66 (náhrada za "2x36W") | 1 x LMA1-1120-120LED-1400-840, 39W, 5340lm, Ra80, 4000K | 6 |
| D2 | COV112-11-840-060-0000 | COVENTINA 112 29W/840 PC/PCO 3690lm 700mA IP66, 5YW | 1 x LMA1-1120-120LED-1400-840, 29W, 3690lm, Ra80, 4000K | 4 |
| E1 | STL030v2 | 25W IDT Pro 2 Streetlight | 1 x STL030v2, 24,2W, 3034,8lm, Ra70, 4000K | 4 |
| F1 | FLD150-D3 | 50w Portland Accent/Billboard/Wall Wash optic Floodlight, 840 | 1 x LED 4000K, 50,9W, 6419lm, Ra80, 4000K | 1 |
| N1 | TM-OS.M2.ST016 | ONTEC S M2 302 M ST COLD | 1 x 010177 14LED, 6,6W, 229lm, Ra80, 5700K | 4 |
| NP1 | EMG019 | 3W Emergency Bulkhead IP65, 765, with Exit Legends / Nouzové svítidlo s piktogramem | 1 x LED, 3,2W, 180lm, Ra70, 6500K | 15 |

Takto označená svítidla jsou vybavena doplňujícím zařízením pro nouzový režim včetně vestavěného akumulátoru, doba autonomnosti svítidla min. 1 hodina